

# How to Register for In-Person EHS Training in Workday

1. From the Workday menu, Click **Learning**.
2. Then select **Discover**.
3. Browse **Learning Topics**.

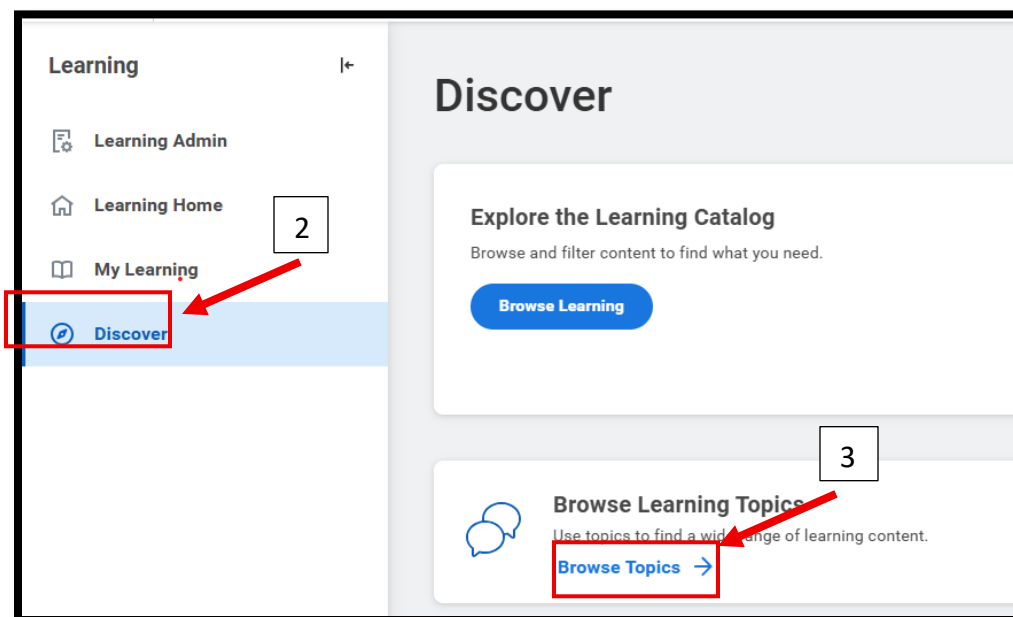
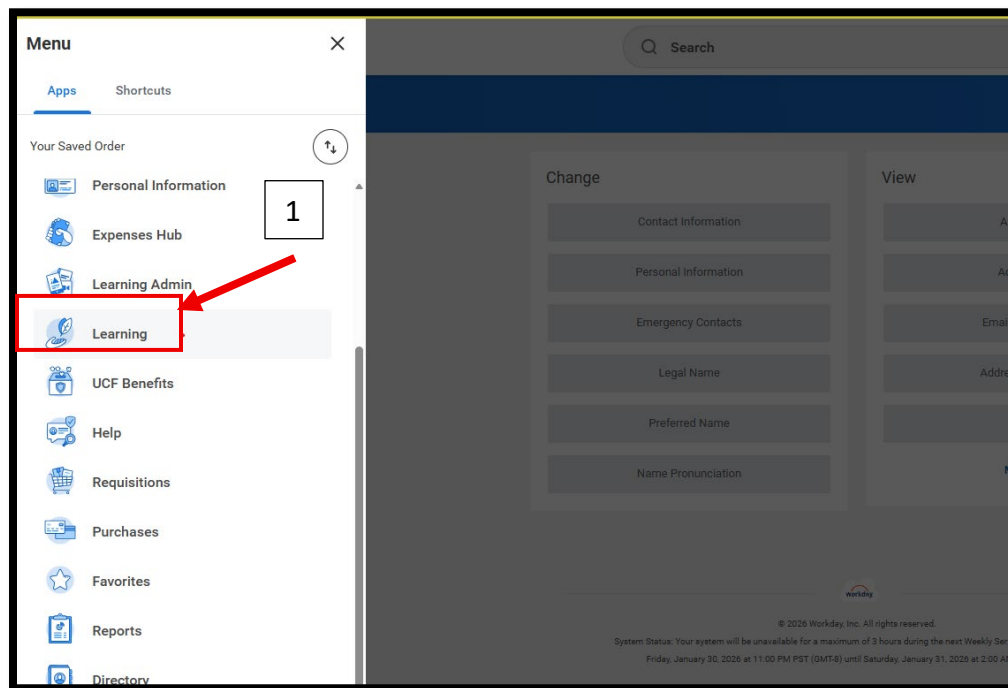

# How to Register for In-Person EHS Training in Workday

4. Select **Environmental Health and Safety** and then choose **Blended Course**.
5. A list of courses available will appear. Select the course you would like to attend.

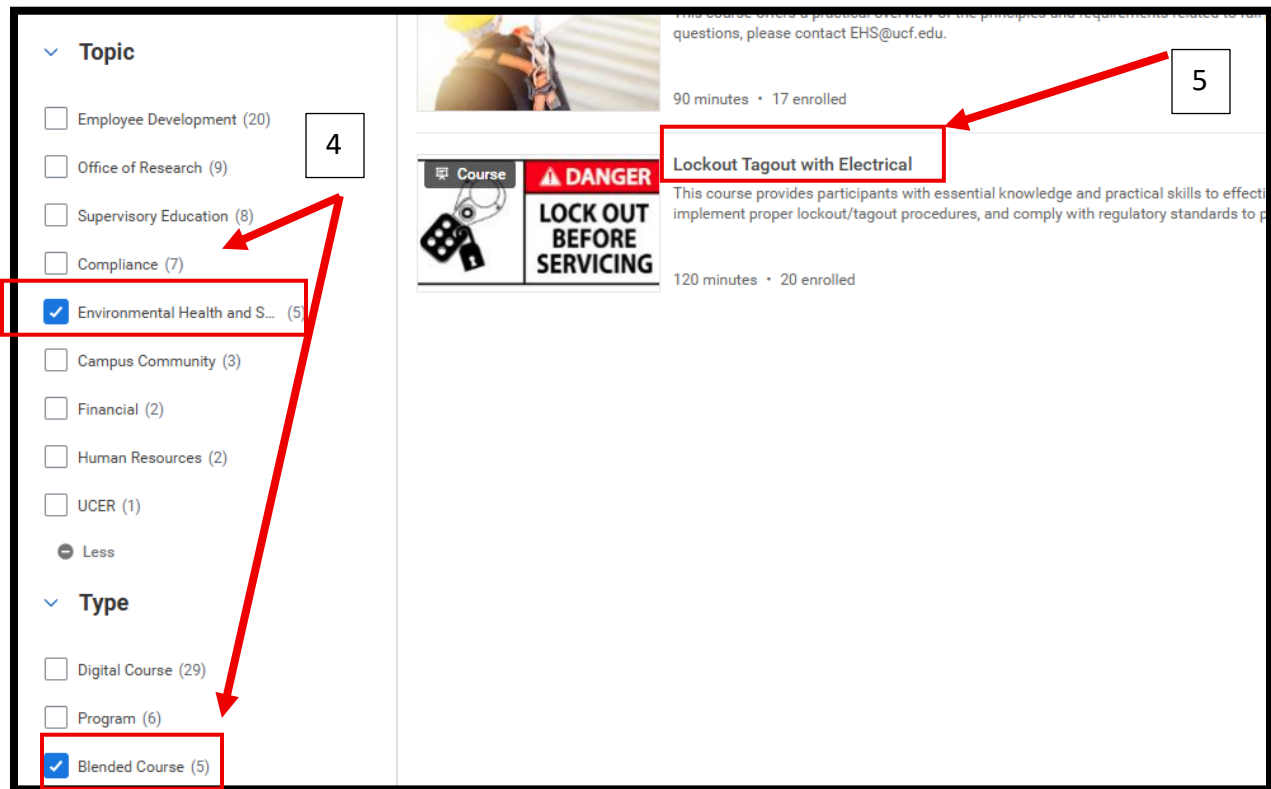

6. Click on **Select Offering** for the course you want to enroll in.

